



# AddBike

## User guide U-Cargo

MARCH 2024

*This document contains information on the correct way to use the U-Cargo. It is imperative that you read this document in its entirety to keep your U-Cargo in good working order for as long as possible.*

Please keep this guide.

# Welcome to the AddBike family!

The U-Cargo is the ideal family bike, designed to meet your daily mobility needs.

It is an urban, versatile, long-tail bike.  
Ride safely with your children and your belongings.

Easy to use thanks to its electric assistance  
and its adaptable equipment!

Before you start cycling, here is some general information:

<b>Transport of children</b>	<ul style="list-style-type: none"><li>• 2 seats available</li><li>• Removable cushions included in the Junior and Family</li><li>• Backrests included in the Family version</li><li>• Divider included for Family version</li></ul>
<b>Available space</b>	<ul style="list-style-type: none"><li>• Available loading area: 60cm x 50cm (length and width)</li><li>• Available volume: 90L (can be extended in height)</li><li>• Loading capacity: between 180kg and 200kg</li></ul>
<b>Rear rack compatibility</b>	Thule - Polisport - Décathlon - Hamax - Bobike - Ortlieb
<b>Front basket</b>	<b>Family version</b> <ul style="list-style-type: none"><li>• Removable front basket (4 screws)</li><li>• Wooden base / Up to 20kg - 30L</li></ul>
<b>Guarantee</b>	Frame: 5 years / Other components: 2 years Spare parts are stored in our warehouse in Lyon.

In the event of technical problems / after-sales service :

- If you bought your U-Cargo from a retailer: contact them directly and they will guide you through the process;
- If you bought your U-Cargo via AddBike, send us the photos and the invoice by email, we will be delighted to help you;
- If your U-Cargo has been commissioned by a partner Technicentre, please contact us directly.

## Electrical parts

<b>Motor</b>	<ul style="list-style-type: none"> <li>• Bafang - BBS01 / Position: Pedal / Power rating: 250W</li> <li>• Torque: 80Nm / Smartphone application: Bafang Go</li> </ul>
<b>Battery</b>	<ul style="list-style-type: none"> <li>• Phyllion SF-06S/ 14.5Ah - 36V - 522Wh</li> <li>• Autonomy: 90 km approx. depending from the assistance mode</li> <li>• Space available for a 2nd battery (with docking)</li> </ul>
<b>Features</b>	Easy-Start : easy start by activating the hand throttle

## Bicycle parts

<b>Frame &amp; Fork</b>	<ul style="list-style-type: none"> <li>• Aluminium frame</li> <li>• Fork wheelbase: 100mm</li> </ul>
<b>Weight &amp; Size</b>	<ul style="list-style-type: none"> <li>• Lite : 31 kg - 190cm (L) x 70 cm handlebar (l) x 120cm (h) / +2nd batterie : +3,5kg</li> <li>• Junior : 39 kg - 205 cm (L) x 70 cm handlebar (l) x 120 cm (h)</li> <li>• Family : 45kg - 205 cm (L) x 70 cm (l) x 110cm (h) /</li> <li>• Protech'360 : 60cm (l) x 110cm (h)</li> </ul>
<b>Wheels</b>	<ul style="list-style-type: none"> <li>• Wheels : Mach1: KARGO 20"</li> <li>• Innova tyres Lite version: 20"x2.40</li> <li>• Schwalbe tyres Junior and Family version: 20x2,4" ref Super moto-X Performance GreenGuard</li> </ul>
<b>Transmission</b>	<p>Lite and Junior version: Cassette 7 speed (with Gear Sensor) / Shimano Shifter / Shimano derailleur / Chain: KMC 11/32</p> <p>Family version: Shimano Nexus hub - with Gear Sensor / Shimano Shifter: Shimano SL-M315 7</p>
<b>Brakes</b>	Hydraulic disc brakes Shimano
<b>Light</b>	Spanninga

## Table of content

1. General warning .....	4
2. U-Cargo glossary .....	6
3. Contents of the U-Cargo box .....	7
4. Verification and safety .....	7
5. Recommendations for use .....	8
6. The U-Cargo in use .....	9
7. Motorisation of your U-Cargo .....	11
8. Transmission .....	12
9. Battery .....	13
10. General settings .....	15
11. Maintenance .....	17
12. U-Cargo transport .....	18
13. Cleaning and storage .....	18
14. Assistance .....	19
15. Warranty .....	19
16. General dimensions .....	20

# 1. General warning

## Global safety guidelines:

The safety instructions are intended to draw your attention to potential dangers. They require your full attention and understanding. **If you ignore a safety instruction, you could injure yourself or others.** The safety instructions alone are not sufficient to prevent hazards; take them into account to avoid the risks associated with using your U-Cargo.

## Symbols and warnings :



### DISCLAIMER!

This symbol indicates a danger that can cause serious injury if the instructions are not followed.



### WARNING!

This symbol indicates a danger that may cause minor injuries if the instructions are not followed.



### ADVICE!

This symbol indicates a tip for the use or maintenance of your AddBike.

As with any conventional bicycle, the use of a U-Cargo involves risks of injury and damage (risk of falls). By using the U-Cargo, you assume full responsibility for these risks; **you must know and apply the rules of the road to travel safely.**

*AddBike and its dealers are not liable for damages resulting from improper use; use your U-Cargo as described in this manual. Any other use is considered improper and can lead to damage to the U-Cargo or even to accidents and serious injury. **The U-Cargo is only intended for use on smooth surface and paths. Be careful not to overload your U-Cargo.***

Read and follow the instructions in this guide: It is necessary to read the whole guide carefully and follow the instructions to use your U-Cargo safely.

If you do not understand any of the instructions, please contact your dealer or contact directly AddBike at the following address: [sales.support@addbike.fr](mailto:sales.support@addbike.fr)

Please keep these instructions for future reference.

AddBike takes no liability for failure of compliance with the instructions in this manual or in case of improper modification of the product by the user.

**Caution:**

Excessive wear and tear, material fatigue or insufficiently tightened screws **can lead to failures that can result in accidents or falls.**

Our advice is to :

- **Regularly check** your U-Cargo to identify any signs of wear and tear,
- Do not use your U-Cargo if you observe **cracks, deformations or colour changes** due to material fatigue,
- **Get your U-Cargo checked.** If you notice excessive wear, loose screws, cracks, deformations or colour changes, please contact your dealer immediately or contact our customer service.

Cargo bikes are exposed to attrition and deterioration, by which the various materials may react differently.

**Worn parts must be replaced.**



**Hard knocks, shocks and tension can damage the frame, forks and wheels.**

## 2. U-Cargo glossary

### U-Cargo Family



### U-Cargo Junior



## Display



## 3. Contents of the U-Cargo box:

- U-Cargo with its battery
- Charger
- QR Code to access all the instructions for use

## 4. Verification and safety:

### Before your first ride:

Your U-Cargo has been initially checked by our engineers and should be ready to drive. Nevertheless, a double check by the user is imperative before the first ride (see the safety checklist):

- Check that the stem is tight; the front wheel must be perfectly aligned with the handlebars,
- Check that the front and rear wheels are tight,
- Check the operation of the brakes by attaching the brake lever,
- Check the tyre pressure,
- Check that the battery is correctly inserted in its housing,
- Check that the front and rear lights are working properly,
- Visually check the rest of the bike,
- Adjust the handlebar height to suit you,
- Adjust the saddle to your height, and try it out in a safe place.

### Before each ride:

- Check that the front and rear lights are working properly,
- Check that the battery is sufficiently charged for the duration of your journey,
- Visually check the rest of the bike,
- Make your usual adjustments for maximum riding comfort



## 5. Recommendations for safe use of the U-Cargo (safety on the road):

The following general safety instructions will help you to use your U-Cargo on the road in the safest possible way:

- Use the U-Cargo **only on surfaces that are suitable for urban bicycles**,
- When cycling, **wear a helmet** that complies with traffic regulations.



We strongly advise to always wear a helmet while riding a bike.

- When travelling with the U-Cargo, light clothing with **reflective bands** should be worn,
- Do not use the U-Cargo if you are under the influence of alcohol, drugs or medication that may impair your driving ability,
- **Do not use portable devices** such as a telephones when cycling,
- When travelling, do not get distracted by other activities such as turning on the lights,
- **Never let go of the handlebars when riding a bicycle except to indicate a change of direction**,
- Ride in a way that does not injure, endanger, block or hinder anyone,
- Preferably ride on cyclable paths designed for bicycles,
- **Drive carefully**, especially in poor visibility,
- Make your movements and changes of direction predictable,
- Announce your intention to turn or overtake in advance with your **bell**.

## 6. The U-Cargo in use:

### Starting:

The U-Cargo turns on **by pressing the "on/off" button on the display** to the left of the handlebars. The electric assistance starts as soon as you start pedalling. To help you start the U-Cargo, press the trigger next to the display (see figure 6).



figure 2 - DP C221 Bafang display

**The level of assistance** is customisable by pressing the UP button  and DOWN button  on the display.

Assistance is adjusted by pressing the plus and minus buttons on the display. You can monitor the battery charge level with the battery on the left of the display, each line representing an equivalent charge of 20%.

**To turn the lights on or off**, press and hold the UP button  for 2 seconds.

### Total maximum weight:

**The maximum load is 180 kg (load + pilot) +20 kg extra with front basket.**

Riding with one or more passengers and/or a heavy load affects the balance, center of gravity and handling of the U-Cargo. The total weight of the bike also affects the braking time.

The maximum load of the U-Cargo must be respected: 20kg in the front basket and 80kg at the back. For passengers, we recommend that no more than two kids are carried.

The weight of the rider and the weight that can be safely carried by the rider are proportional. The load should not exceed 80% of the riders' weight.



**Familiarise yourself driving the bike loaded in a safe setting before driving on the road.**



## Driving the U-Cargo with kids:

You can install and use one or two child seats as long as they are road approved.

In terms of compatibility, our rack can accommodate both longitudinally and transversely mounted seats.

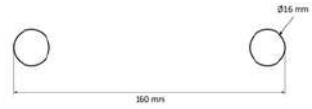

figure 3- Geometry for hosting cross-connection system

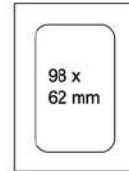

figure 4- Geometry for hosting longitudinal hooking system

### AddBike cushions:

The AddBike cushions are designed for preschooler/school-aged kids. They are easy to install thanks to the scratch system.



figure 5- AddBike child cushions

## Driving the U-Cargo to transport loads:

### Front Basket:

The front basket can hold a load max of 20kg. Large loads should be avoided, as they could interfere with the riding. Before starting, check that your handlebar can turn smoothly and that the brake levers do not touch your load.



**Please note that this front basket is not intended to carry a passenger under any circumstances.**

### Back rack:

For steering, it is best to position the load so that the centre of gravity is close to the centre of the U-Cargo. Distribute your cargo evenly on the platforms on either side of the bike.



**After braking, the discs can be very hot. Be careful not to burn yourself and warn the passengers.**

## 7. Motorisation of your U-Cargo :

### The motor:

Electrically assisted bicycles or e-bikes are equipped with an electric motor that provides pedalling assistance.

To be classified as an **ECV** according to European regulations, your bike must respect 3 simple rules:

- The assistance should only be activated when the motor detects that you are pedalling,
- The assistance must be switched off when you exceed 25km/h,
- The motor must not exceed the rated power of 250W.

The motor of the U-Cargo is a **Bafang** pedal motor, model BBS01, with a torque of 80Nm. It complies with the regulations in force.

### Easy-Start assistance:

The trigger on the left side of the handlebar allows assistance to start riding without having to cycle to start the motor.



**Be careful not to activate the Easy-Start when you are not on the bike.**



figure 6- Trigger for Easy-Start



**Switch off the bike as soon as you park to avoid unintentional activation of the start assistance.**

### Walking assistance: (not to be confused with Easy-Start assistance)

Motor assistance for pushing the bike while walking. To activate it:

To activate: Press the button  until the symbol  appears.

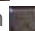
Then press and hold the button  while the symbol is displayed.

The symbol flashes  and the ECV moves at approximately 4.5 km/h.

After releasing the button  or if no other button is pressed within 5 seconds, the motor stops automatically and returns to level 0.

## 8. The transmission :

### Transmission:

For the Lite and Junior version :

7 speed cassette

Shifter Shimano

With Gear Sensor

Derailleur Shimano

Chain: KMC 11/32

### For the Family version :

Shimano Nexus hub – Gear Sensor

Shimano Shifter: Shimano SL-M315 7



Nexus sur le U-Cargo Family

Internal gearboxes require no day-to-day maintenance, nevertheless, the oil inside must be changed from time to time (the manufacturer recommends an oil change every 10,000 km). Your local bike shop can help you with that.

Proper lubrication of the chain will significantly increase its life and pedalling comfort. Use an oil intended for this purpose. If in doubt, ask your bicycle dealer for advice.

## 9. Battery:

### Technical characteristics:

- Phylion battery SF-06s
- BAK cells: 14.5Ah – 36V – 522 Wh
- 700 load cycles
- Average autonomy: approx. 90 km (depending on the assistance mode used)

### Optional battery :

- 17.05 Ah - 36 V - 630 Wh
- 700 charge cycles
- Range: approx. 110 km (depending on the assistance mode used)



figure 9- Engaging the battery in its cradle

### Use and charge:

**To remove the battery** from the U-Cargo, you must insert the key into the lock on the left side of the battery, turn the key a quarter turn, push the top of the battery to the right and release the battery from its slot.

**To put it back on**, do the opposite. Note that it is not necessary to turn the key this time. When you put the battery back in, make sure that it is well positioned in its slot.

### Avoid driving with the keys on the battery.

You can **monitor the battery charge level on the display** but also on the battery itself when it is not attached to the bike. To do this, simply press the button next to the blue LEDs on the right side of the battery.



figure 10- Battery charge indicator

To **recharge the battery**, a connector is located on the right side of the battery, under the blue LEDs.

It is best to start by connecting the charger to the battery, following by plugging the charger into the outlet.



figure 11- Charger connector

**Your U-Cargo is equipped with a lithium-ion battery.**

Modern lithium-ion batteries have a maximum charge and discharge cycle of more than 700 cycles before the battery's capacity is reduced.

You can recharge your battery at any time and there is no need to wait until the battery is completely discharged before you can recharge it.



**If you are not going to ride your bike for more than a month, recharge the battery to 70% before storing it.**

It is not recommended to leave your battery discharged for a long period of time. If you do not use your U-Cargo for a long time, remember to recharge your battery at least once a month (the manufacturer recommends a minimum of one charge per month).



**For safety reasons, always use the original charger supplied with your U-Cargo.**

For more convenience, you can buy a second charger that will allow you to charge, for example, at home but also at work.

**Maintenance and service:**Cleaning:

**To clean the battery**, preferably use a slightly damp cloth.

Service and user advice:

Our after-sales service and your bicycle dealer are at your service in case of any doubts about the proper functioning of your battery. Do not hesitate to consult us in case of shocks, cracks or swelling.

End of life:

When your battery reaches **the end of its life**, it should be treated as hazardous waste and **not disposed of in a normal waste bin.**

Ask your dealer about the best place to recycle your battery.

## 10. General settings:

### Driving position:

Thanks to the combination of stem, handlebar and saddle adjustments, everyone can find their ideal position on the U-Cargo.

The U-Cargo is designed to be used by people between 1.5 and 2 metres tall. As a general rule, it is recommended to choose a slightly forward-leaning position; a perfectly upright position should be reserved for very short trips.

### Saddle :

The height of the saddle is an important part of the overall riding position. You can easily adjust the saddle height with the large lever on the saddle clamp. The saddle can be adjusted up and down, front and back and tilted up or down, and is neutrally adjusted at the factory. **You can adjust it to your needs.** Your bike shop will be able to help you find the optimum setting for you.



figure 12- Saddle height adjustment lever

### Handlebars and stem:

**The U-Cargo stem is adjustable in angle and height.**

If you are not used to handling these components we advise you to contact your bike shop.

For the handlebars, the palm of your hands should rest comfortably on the grips, your fingers should easily reach the brake levers, the gear lever and the bell



figure 13- Adjustable stem



## Lights:

The U-Cargo is equipped **with Spanninga lights**.

- The front light is the **Axendo 40**, for 40 lux
- The rear light is the **Elips** with 6 powerful red LEDs.

The beam of light from the front lighting should be adjusted to illuminate the road as far as possible while making sure not to dazzle people around you.

## Tightening the screws:

Recommended tools and tightening torques for the U-Cargo :

Componant	Tool	Torque
Display	Allen key 2.5	3 Nm
Trigger to start	Allen key 3	3 Nm
Stem (4 handlebar fixing screws)	Allen key 4	5-6 Nm
Stem (1 headset adjustment screw)	Allen key 5	to adjust
Stem (2 angle adjustment screws)	Allen key 5	14- 15 Nm
Stem (2 screws on fork)	Allen key 5	9-10 Nm
Brake levers	Allen key 4	5-6 Nm
Gear lever	Allen key 5	5-6 Nm
Saddle	Allen key 5	9-10 Nm
Front wheel	Spanner 15	20 Nm
Back wheel	Spanner 15	30 Nm
Brake discs	Torx key T25	5-6 Nm
Cranks	Allen key 8	35 Nm
Kickstand	Allen key 8	35 Nm

**Tyre pressure:**

**Check that the tyre pressure is within the recommended values.** These are always marked on the side of your tyres: **2.4 - 4.2 bar**.

Low pressure helps passenger comfort, high pressure makes for a more dynamic ride.

If you are driving with a very **heavy load**, you should **use a high pressure**.

To re-inflate the tyres, use a pump or compressor with a nozzle suitable for Schrader valves. Schrader valves are the same as those used in cars. Be sure to keep the valve caps, as they protect the valve tips from dirt and help seal them.

**Adjusting the rear-view mirror:**

Depending on your needs, you can add a rear-view mirror and choose to set it to monitor your surroundings (cars, bicycles) or to maintain visual contact with your passengers.

## 11. Maintaining your U-Cargo :

The U-Cargo has been designed for use **in normal weather conditions**. Avoid ice, hail and other extreme weather conditions.

**Regular maintenance:**

- **Brakes:**

Monitor the condition of your brake pads.

Riding with damaged pads will damage the condition of the discs.

- **Chain:**

Lubricate the chain regularly with a suitable oil.

- **Fasteners and quick-releases:**

Check the tightness of screws and quick-releases regularly.

- **Spoke tensions:**

The wheels of cargo bikes support lots of stressors. Make sure that the spokes remain tight. If in doubt, consult your bicycle dealer as soon as possible.

- **Possible damage due to intensive use:**

Like any mechanical component, a bicycle is subject to high stress and wear. Different materials and components can react differently to wear or fatigue. If a component has exceeded its life expectancy, it may suddenly break, with the risk of injury.



If possible, store your U-Cargo away from the sun and rain.

Cracks, scratches and discolouration in areas of high stress indicate that the component has exceeded its usability and should be replaced.

## 12. Transport of the U-Cargo

### Trains and public transport:

E-Bikes can generally be carried on trains and public transport in the same way as conventional bicycles. Check with the train or public transport company for particular requirements.

## 13. Cleaning and storage

You can **clean your U-Cargo** with water and mild cleaning products. You can use a sponge.

**Do not get the electrical circuits, battery and battery tray, motor and display wet.** Do not clean your bike with a high-pressure cleaner, as this may cause damage that is not covered by the warranty. Remember to regularly clean and treat wooden surfaces (basket, steps) for prolonged use.

### Battery storage and management:

The battery should be stored under the conditions listed below for optimum battery life and efficiency:

- Remove the battery from the U-Cargo **before storing it.** Check **the charge level** and **make sure that 3 or 4 LEDs are lit on your battery.**
- Store the lithium battery in a **dark, dry and temperate place.**
- Store your **lithium-ion batteries in a safe place and out of reach of children.**

## 14. Assistance in case of problems:

If any part of the U-Cargo fails to properly function, please contact AddBike ([sales.support@addbike.fr](mailto:sales.support@addbike.fr)) or your dealer.

**We will do our best to help you solve the problem as soon as possible.** You can find a list of trained AddBike dealers at [www.add-bike.com](http://www.add-bike.com).

## 15. Guarantee:

In accordance with the law, the U-Cargo product warranty **extends up to 2 years** after purchase for electrical and electronic parts.

- The frame is guaranteed for 5 years,
- The mechanical components (excluding wearing parts) are guaranteed for 2 years, the date shown on your invoice being proof of this.

**The product must be used in accordance with its use and assembly instructions and regularly maintained.**

Original parts must not be replaced **by non-approved parts**. Damage resulting from improper use, abuse, inadequate maintenance or normal wear and tear is excluded from the warranty.

Our products contain components and parts (tyres, brake pads, tubes) that are subject to natural wear and tear during normal use. These parts are not covered by the warranty.

## Any questions ?

Contact us

 + 33 6 38 02 52 58

 [sales.support@addbike.fr](mailto:sales.support@addbike.fr)

 [www.add-bike.com/en/](http://www.add-bike.com/en/)

## 16. General dimensions

